



Designed for use at home, the CUBE Lite MONITOR contains a 2.1 ch speaker system that gives you great-sounding audio playback as well as the quality you expect from a stereo monitor amp.

- With specially designed stereo speakers and subwoofer, this unit delivers powerful lows and faithfully reproduces your instrumental and vocal performances.
- The i-CUBE LINK function lets you use your iPad/iPhone app to record and play back an instrumental or vocal performance, and apply effects to it.

Before using this unit, carefully read the sections entitled "USING THE UNIT SAFELY" and "IMPORTANT NOTES" (separate sheet). These sections provide important information concerning the proper operation of the unit. Additionally, in order to feel assured that you have gained a good grasp of every feature of your new unit, read Owner's manual in its entirety. This manual should be saved and kept on hand as a convenient reference.

Copyright © 2012 ROLAND CORPORATION

All rights reserved.

No part of this publication may be reproduced in any form without the written permission of ROLAND CORPORATION.

Top Panel (Adjusting the Sound of a Line-Level Device or Microphone)

Mode switch/Indicator

Set the mode appropriately for the device you've connected.

Indicator	Mode	Explanation
Green	STEREO	When a keyboard or other line-level device is connected to the STEREO jacks.
Red	MIC	When a microphone is connected to the MIC jack.

Anti-feedback Function

When the mode is set to "MIC," the anti-feedback function will suppress acoustic feedback (howling).

- * This works only with respect to the input from the MIC jack.
- * If the anti-feedback function is not enough to suppress feedback, take the following steps.
 - Change the direction of the microphone
 - Move the microphone away from the speakers
 - Lower the volume



[VOLUME] knob

Adjusts the volume.

[LOW] knob

Adjusts the volume of the lower range.

[MIDDLE] knob

Adjusts the volume of the middle range.

[HIGH] knob

Adjusts the volume of the upper range.

[REVERB/ECHO] knob

Change the position of this knob to switch between reverb and echo. The position of the knob determines the depth of the effect.

DC IN jack

Connect the included AC adaptor here.
* Use only the included AC adaptor. The use of any other AC adaptor may cause malfunction.

Rear Panel (Connecting Your Equipment)

PHONES jack

Connect headphones equipped with a stereo mini-plug.

STEREO/MIC jacks

Select either STEREO or MIC using the Mode switch on the top panel.

STEREO L (MONO), R

Connect a keyboard or other line-level device.

MIC (MIC, LINE)

Connect your microphone to the MIC jack. You can connect a keyboard or other line-level device to the LINE jack, and use it simultaneously with a microphone.

* The LINE jack is a monaural input.

* The top panel knobs affect both the MIC jack and LINE jack.

If you want to adjust the volume of the microphone and line-level device separately, use the controls of your line-level device to adjust its volume.

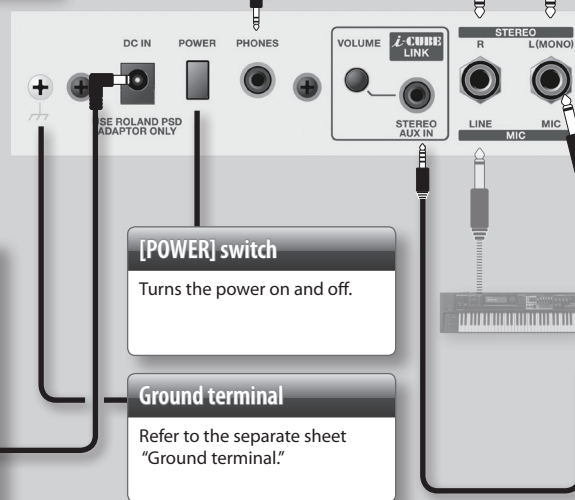

[POWER] switch

Turns the power on and off.

Ground terminal

Refer to the separate sheet "Ground terminal."

i-CUBE LINK/STEREO AUX IN jack (dual function)

i-CUBE LINK

If you use the included mini cable (4-pole) to connect your iPad/iPhone, you'll be able to use the i-CUBE LINK function.

STEREO AUX IN

Use the included mini cable (4-pole) or a commercially available stereo-mini cable to connect your digital audio player or iPad/iPhone here.

[VOLUME] knob

Adjusts the volume of the input from the connected device.

NOTE

To prevent malfunction and equipment failure, always turn down the volume, and turn off all the units before making any connections.

Turning the Power On and Off

- Once everything is properly connected, be sure to follow the procedure below to turn on their power. If you turn on equipment in the wrong order, you risk causing malfunction or equipment failure.

When turning the power on: Turn on the CUBE Lite MONITOR last.

When turning the power off: Turn off the CUBE Lite MONITOR first.

- This unit is equipped with a protection circuit. A brief interval (a few seconds) after turning the unit on is required before it will operate normally.

Using i-CUBE LINK

"i-CUBE LINK" is a function that allows the CUBE Lite MONITOR to be used simultaneously for conventional AUX IN and as an audio interface for your iPad/iPhone when the iPad/iPhone is connected via the included mini cable (4-pole).

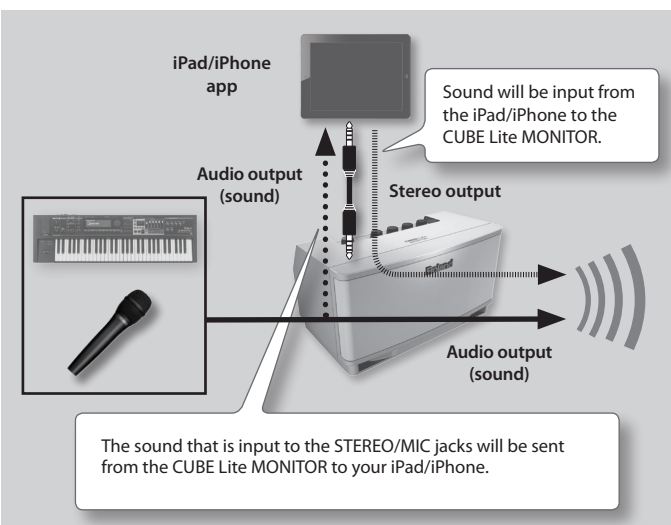

By making use of this function, you can do things such as the following:

- Record the audio from the line-level device or microphone using your iPad/iPhone app, then play it back
- Produce the sound from the line-level device or microphone after you've used your iPad/iPhone app to apply effects to it

* If you only want to produce the sound that's being input to the CUBE Lite MONITOR after it has passed through your iPad/iPhone, minimize the [VOLUME] knob on the top panel.

You can choose one of the following two types of sound to be sent to the iPad/iPhone.

* Even if the input is stereo, it will be sent as monaural.

Line Mode (default setting)	The same sound as heard from the CUBE Lite MONITOR's speakers will be sent.
Direct Mode	The sound being input to the STEREO/MIC jacks will be sent without modification.

To select Direct Mode

1. While holding down the Mode switch, press the [POWER] switch to turn on the CUBE Lite MONITOR's power.



To return to Line mode, turn the CUBE Lite MONITOR's power off, then on again.

For details on i-CUBE LINK and on iPhone/iPad apps that can use i-CUBE LINK, refer to Roland website.

<http://www.roland.com/>

Specifications

Roland CUBE Lite MONITOR: Monitor Amplifier

Rated Power Output	10W (Stereo speakers 3 W x 2 + Subwoofer 4 W)
Nominal Input Level (1 kHz)	<STEREO MODE> L (MONO), R: -20 dBu <MIC MODE> MIC: -40 dBu LINE: -20 dBu i-CUBE LINK/STEREO AUX IN: -10 dBu
Speakers	7.5 cm (3 inches) x 3
Controls	POWER switch Mode switch (STEREO/MIC) VOLUME knob LOW knob MIDDLE knob HIGH knob REVERB/ECHO knob <i-CUBE LINK/STEREO AUX IN> VOLUME knob

Indicator	Mode (STEREO/MIC)
Connectors	L (MONO)/MIC jack: 1/4-inch phone type R/LINE jack: 1/4-inch phone type i-CUBE LINK/STEREO AUX IN jack: 4-pole miniature phone type PHONES jack: Stereo miniature phone type DC IN jack
Power Supply	AC adaptor (DC 5.7 V)
Current Draw	1000 mA
Dimensions	250 (W) x 147 (D) x 135 (H) mm 9-7/8 (W) x 5-13/16 (D) x 5-3/8 (H) inches
Weight	1.7 kg/3 lbs 12 oz (excluding AC adaptor)
Accessories	Owner's Manual AC adaptor Mini cable (4 poles)

* 0 dBu = 0.775 Vrms

* In the interest of product improvement, the specifications and/or appearance of this unit are subject to change without prior notice.

Guide pin

You can connect a commercially available wire here to secure the CUBE Lite MONITOR.

* To prevent damage, do not apply excessive force to the guide pin.

