

Roland Sound Library

SR-JV80-04

“Vintage Synth” Expansion Board

Copyright © 1993 ROLAND CORPORATION

All rights reserved. No part of this publication may be reproduced in any form without the permission of ROLAND CORPORATION.

本書の一部、もしくは全部を無断で複写・転載することを禁じます。

Thank you for purchasing the Roland Sound Library SR-JV80-04 “Vintage Synth” Expansion Board.

This Expansion Board contains 255 different Waves from not only renowned Roland synthesizers (including waveforms from the SH-1000 and D-50), but also waveforms from classic synthesizers of other manufacturers. It also contains 255 different Patches each for JV series instruments and the JD-990, created utilizing the Waves in the Expansion Board and those in the specific instrument. (Note: The JD-990 can read Patches for the JV series synthesizers (as well as those specially created for it), allowing you to use total of 510 Patches.)

このたびは、ローランド・サウンド・ライブラリー SR-JV80-04 「ビンテージ・シンセ」をお買い上げいただきまして、まことにありがとうございます。

このエクспанション・ボードには、SH-1000からD-50に至る歴代のローランド・シンセ・サウンドはもちろん、内外の名器と呼ばれるシンセサイザーの音源波形からその機種ならではのシンセ・サウンドなど、多種多様なウェーブが255種類、エクспанション・ボードおよび本体のウェーブを使用して作られたパッチがJVシリーズ用、JD-990用にそれぞれ255種類収められています。(注:JD-990ではJVシリーズのパッチも読むことが可能です。したがって、計510個のパッチを使うことができます。)

■ INSTALLING THE EXPANSION BOARD

* Turn off your instrument.

1. Remove the cover located on the bottom (or top) of your instrument.
2. Rotate the board holders so they align with the connector.
3. Mount the Expansion Board on the connector so the three board holders project through the Expansion Board.
4. Affix the Expansion Board by using the attached tool to turn the board holders in the LOCK direction.
(To remove the Expansion Board, turn the board holders in the UNLOCK direction and hook the board with the provided tool. Remove the board and secure the cover plate).
5. Check if the Expansion Board is correctly installed.
If the “EXP” display is not selected (shown) in the Waveform Selection Screen (refer to the owner’s manual of the instrument you use), remove the Expansion Board and install it properly.

■ エクспанション・ボードの取り付けかた

* 使用機器の電源スイッチをオフにしてください。

1. 使用機器の底部、または上部にあるカバーをはずします。
2. 基板ホルダーを、図2のような向きに合わせます。
3. エクспанション・ボードのコネクターを、本体のコネクターに完全に差し込みます。このとき3つの基板ホルダーが、エクспанション・ボードから出るようにします。
4. 付属の固定用具で基板ホルダーをLOCK方向に回し、エクспанション・ボードを固定します。
エクспанション・ボードの取りはずしは、基板ホルダーをUNLOCK方向に回し、固定用具を引っ掛けて取りはずします。最後にカバーを取り付けます。
5. エクспанション・ボードの取り付けが正しく行なわれたかを確認します。
ウェーブフォームの選択画面(使用機器の取扱説明書参照)で“EXP”が選ばない(表示されない)ときは、もう一度エクспанション・ボードをつけ直してください。

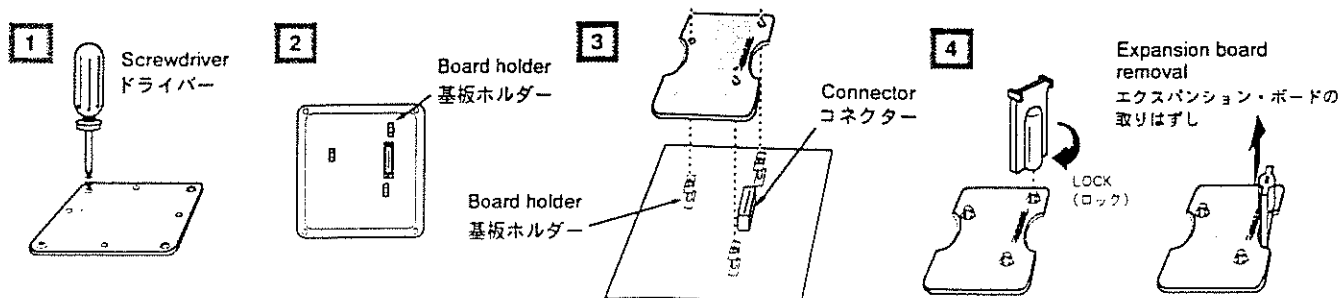

■ LOADING PATCH DATA

To use Patch data stored in the Expansion Board, load the relevant Patch data according to the owner’s manual of the instrument you use.

■ パッチのロード

エクспанション・ボードのパッチを使うときは、使用機器の取扱説明書に従って、パッチ・データのロードを実行してください。

■ JD-990 をお使いのお客様へ

- まず始めに、JD-990 専用パッチの音を聴いてみてください。
- JV シリーズ用のパッチをコンバート・ロードして使用した場合、JV シリーズで使用したときの音色とは多少異なりますので、本体で音色を修正してください。
- JV シリーズ/JD-990 専用のパッチ・リストの両方に同じ名前のパッチがありますが、音色は異なります。
- ウェーブ・リストの中で、名前に“REV”が付いているウェーブフォームはリバース(逆方向)再生で発音するようになっていますが、JD-990 ではリバース再生ができないため、正方向再生で代用して発音します。

PATCH LIST for JD-990

No.	Name
001 (A11)	Portamental
002 (A12)	Reanimator
003 (A13)	Autoglider
004 (A14)	Andromida Wash
005 (A15)	Warm Shimmer
006 (A16)	Spacial Echoes 1
007 (A17)	Spacial Echoes 2
008 (A18)	Mourning Android
009 (A21)	Aviary Pad
010 (A22)	Vectoring Propht
011 (A23)	Phazamento
012 (A24)	Dreamsweep
013 (A25)	Germans
014 (A26)	Skip to my Wave
015 (A27)	Pulsing Glass
016 (A28)	2.3 Split
017 (A31)	Thong Shimmer
018 (A32)	Wavetabling
019 (A33)	Circular Shapes
020 (A34)	Waveternr Slide
021 (A35)	Sergelow
022 (A36)	Big Digibell
023 (A37)	Translucent Keys
024 (A38)	VS+D50+Wave
025 (A41)	Micro Moves
026 (A42)	JP - 8 Silk Pad
027 (A43)	Ultra Warm Pad
028 (A44)	JP - 8 Hollow STR
029 (A45)	CS - Strings - 80
030 (A46)	Pro - 10 Strings
031 (A47)	Omni II
032 (A48)	Solina Bi - Phase
033 (A51)	70's StringLayer
034 (A52)	Europa Strings
035 (A53)	Memory MG Pad 1
036 (A54)	Memory MG Pad 2
037 (A55)	OB Thick & Quick
038 (A56)	Soundtrack Ens.
039 (A57)	Background Pad
040 (A58)	Flowing Strings
041 (A61)	Bomber Strings
042 (A62)	Juno STR Sweep
043 (A63)	Ober - swell - heim
044 (A64)	OB8 - voice Swell
045 (A65)	Xa Brass Pad
046 (A66)	T8 Touch Strings
047 (A67)	Pea Soup Pad
048 (A68)	JP - 8 Thick PWM
049 (A71)	CS Pulse Pad
050 (A72)	Sublime Pulse
051 (A73)	Pitchy Jupiters
052 (A74)	Haunting Pulse
053 (A75)	Velo BPF Pad
054 (A76)	D - 70 Nomad
055 (A77)	JX Rezsawsweep
056 (A78)	Pro10 & SeeEss80
057 (A81)	Living Forest
058 (A82)	Chariots
059 (A83)	CS - Eighty Sweep
060 (A84)	CS - HPF Rise - 80
061 (A85)	Voyager - Eight
062 (A86)	Fizzly Pad
063 (A87)	Glassy Rezopad
064 (A88)	OB-JP Hollowed 1

No.	Name
065 (B11)	OB+JP Hollowed 2
066 (B12)	Hollowed Vector
067 (B13)	Smooth & Square
068 (B14)	Haunting Triangl
069 (B15)	JX Hollow Drone
070 (B16)	Hollow Stack
071 (B17)	Juno - 6 Organ Pad
072 (B18)	VP - 330 Choir
073 (B21)	Europa Vox Pad
074 (B22)	VP330 Afterglow
075 (B23)	Analog Choir
076 (B24)	Massed Choirs
077 (B25)	JX - 8P Hollow Vox
078 (B26)	Somewhere JX
079 (B27)	JX10 Tetra Voice
080 (B28)	Palpitating Vox
081 (B31)	Atlantis Vox
082 (B32)	Lite Bright
083 (B33)	Ring the Bellz
084 (B34)	Jupiter - 6 Bells1
085 (B35)	Jupiter - 6 Bells2
086 (B36)	Jupiter - 6 Mystic
087 (B37)	Snow Lake
088 (B38)	Polymod Noizbell
089 (B41)	Weightless
090 (B42)	Time flies 990
091 (B43)	D50 Ring E.Piano
092 (B44)	MKS - 10 Ac.Piano
093 (B45)	D50 Stacc.Heaven
094 (B46)	90's Future Pad
095 (B47)	Drippy Pad
096 (B48)	Twinkle Pad
097 (B51)	Shining Flute
098 (B52)	Thailand
099 (B53)	Clipped 70s Keys
100 (B54)	80's Digipower
101 (B55)	Mondo Digital
102 (B56)	Jupiter - 8 Clav
103 (B57)	Mondo Alpha Juno
104 (B58)	CS Eightee Pulse
105 (B61)	OB 8voice Poly
106 (B62)	Pulsey Heaven
107 (B63)	JP - 8 PWM Power
108 (B64)	Perkin' Poly
109 (B65)	FAT Memory MG
110 (B66)	Trident Brazz
111 (B67)	Poly Band Pass
112 (B68)	Rezo BPF Sweep
113 (B71)	Fat? Maybe so!
114 (B72)	...to the Walls!
115 (B73)	Pro - 10 Poly
116 (B74)	80's O - B - X - a
117 (B75)	Mother Matrix
118 (B76)	T8 Detune Comp
119 (B77)	Bouncy Thang
120 (B78)	Power Juno
121 (B81)	SuperJup Brass
122 (B82)	Eddies CS - Eighty
123 (B83)	Bendy GX - One
124 (B84)	Ancient Times V
125 (B85)	OB - Poly Brass - X
126 (B86)	OB - Stab Brass - X
127 (B87)	Blow Big Matrix
128 (B88)	Sharp JP - 4 Brs

No.	Name
129 (C11)	Fanfarezo
130 (C12)	Khroma Brass
131 (C13)	X - pandr Soft Brs
132 (C14)	JX - 3P Brass
133 (C15)	CS - Brass Pad - 80
134 (C16)	Wasp Jumps
135 (C17)	U.K. Waspy
136 (C18)	Mini MG Lead 1
137 (C21)	Mini & Echo - plex
138 (C22)	Mini + S.E.M.
139 (C23)	Mono - poly Lead
140 (C24)	Progressive Lead
141 (C25)	Pro - 5 Lead
142 (C28)	MKS - 80 Lead
143 (C27)	GR - 300 Lead
144 (C28)	GR - 300 Duet
145 (C31)	Adrian's GR - 300
146 (C32)	GR - 700 Brass
147 (C33)	Relayer Lead
148 (C34)	Delirium Lead
149 (C35)	System - 100M Lead
150 (C36)	Tiracon
151 (C37)	Disruption
152 (C38)	Serious Syncin'
153 (C41)	Trippy 70's Solo
154 (C42)	Noo Eff Emm Lead
155 (C43)	Analimba Lead
156 (C44)	Solo in Fog
157 (C45)	Histal Lead
158 (C46)	James Layer
159 (C47)	Hollow OB - one
160 (C48)	Fast System - 15
161 (C51)	OB 2voice Lead
162 (C52)	Spacy Lead
163 (C53)	Piper Peters
164 (C54)	Ultimate Cheese
165 (C55)	Mondo MG Bass
166 (C56)	Tuff Mini Bass
167 (C57)	Phat Phaser Bass
168 (C58)	Spike it Bass
169 (C61)	Bi - Phase Bass
170 (C62)	MIDI'ed Oscar
171 (C63)	Big Bottom
172 (C64)	Classic MG Bass
173 (C65)	Classic MG w/Phz
174 (C66)	SH - 5 Solid Bass
175 (C67)	Modwheel Drone
176 (C68)	T - II Bass Pedals
177 (C71)	Raw Oscillators
178 (C72)	Bulbus Bass
179 (C73)	SH101 House Bass
180 (C74)	SH101 Organ Bass
181 (C75)	SH101 Thip Bass
182 (C76)	SH101 Mute Bass
183 (C77)	X - pander Bass
184 (C78)	Prophetic Bass
185 (C81)	OB Phaser Bass
186 (C82)	OB House Bass
187 (C83)	JP - 4 Rezo Bass
188 (C84)	JP - 4 Sub - Osc Bs
189 (C85)	JP - 4 Sharp Subs
190 (C86)	Octaver Bass
191 (C87)	MKS - 70 Wet Bass
192 (C88)	System 700 Bass1

No.	Name
193 (D11)	System 700 Bass2
194 (D12)	Acid Bassline303
195 (D13)	4 Pole Wow Bass
196 (D14)	Juno - 60 RezoBass
197 (D15)	Industrial Bass1
198 (D16)	Industrial Bass2
199 (D17)	Steemer Bass
200 (D18)	Rave Bass
201 (D21)	Mini Velo Blips
202 (D22)	Robonoize
203 (D23)	Zone Rouge Hit
204 (D24)	Cyberpunk Mod.Wh
205 (D25)	Industrial Waste
206 (D26)	EML Grunge 5ths
207 (D27)	MG Ext.in Feedbk
208 (D28)	EML Wobbler
209 (D31)	Techno Cat
210 (D32)	Putney Ramper
211 (D33)	960 Sequence
212 (D34)	System700 Panner
213 (D35)	OB - VCF S&H - Xa
214 (D36)	System - 700 S&H
215 (D37)	AKS S&H Overload
216 (D38)	SEQ Sweeper
217 (D41)	SH - 2 Popcorn
218 (D42)	Jupiter Popcorn
219 (D43)	Backfire SEQ
220 (D44)	Syn Harp - rp - p
221 (D45)	Mr.B!
222 (D46)	Purple & Deep
223 (D47)	Tent Meeting v/s
224 (D48)	Spinning Horns
225 (D51)	Wavyorgan
226 (D52)	Rotary Strings
227 (D53)	Soapy Organ
228 (D54)	Swirly Organ
229 (D55)	Juno Organ
230 (D56)	Alpha Pipes
231 (D57)	Phat Phaser Strings
232 (D58)	In the Court...
233 (D61)	Dark & Somber
234 (D62)	Middle Age Dream
235 (D63)	WatcherOfTheSkys
236 (D64)	Mello & Moody
237 (D65)	Tron Storm
238 (D66)	Tape Echo 990
239 (D67)	Big Tron Vox
240 (D68)	All The Tapes
241 (D71)	Atmoswell
242 (D72)	Throbbing
243 (D73)	Computing
244 (D74)	Death Race 2000
245 (D75)	Future Siren
246 (D76)	Catch me!
247 (D77)	Catch the Wasp
248 (D78)	VCF Reso S&H
249 (D81)	VCF Reso 2600
250 (D82)	2199 Bath House
251 (D83)	Aural Enigma 990
252 (D84)	Depth Charge
253 (D85)	Ringin' Falls
254 (D86)	Eject!
255 (D87)	Time Warp

■ To users of the JD-990

- First of all, listen to the Patches provided specially for the JD-990.
- If you have loaded any of the Patches for the JV series into the JD-990 with Convert Load, they may sound slightly different from when played on a JV synthesizer. You should modify the sound on the JD-990.
- There are some Patches that share the same names on the lists of the JV series and JD-990, but they are completely different sounds.
- The waves marked "REV" in the Wave List are triggered backwards by the JV series. However, the JD-990 does not have the ability to play these waves backwards and therefore plays them normally.

PATCH LIST for JV series

No.	Name
001 (A11)	Prologue
002 (A12)	EasternTempl
003 (A13)	Replicants
004 (A14)	Converge
005 (A15)	JX3P Polaris
006 (A16)	Big Pad Swp
007 (A17)	Big LFOSweep
008 (A18)	Animotion
009 (A21)	Mega 5ths
010 (A22)	CS - Sixty BPF
011 (A23)	Waspy Synth
012 (A24)	Polychrome
013 (A25)	Euro Sweep
014 (A26)	OBig Poly
015 (A27)	OB Synth
016 (A28)	80s OBxa
017 (A31)	Thick Matrix
018 (A32)	Poly X - pandr
019 (A33)	Synth - X Poly
020 (A34)	Prophetic
021 (A35)	Oct MG Saw
022 (A36)	Juno - 6 Power
023 (A37)	Hyperphases
024 (A38)	Synth - X Phaz
025 (A41)	MiDi Brs Pad
028 (A42)	Poly Palette
027 (A43)	Spit Brass
028 (A44)	Pro - 10 Brass
029 (A45)	OB Stab Brs
030 (A46)	Pro - 5 Brass
031 (A47)	MKS - 7 Brass
032 (A48)	Quack Brass
033 (A51)	MemoryMG Brs
034 (A52)	FM Brass
035 (A53)	Ghost Blow
036 (A54)	Metal Drone
037 (A55)	Rotary Strng
038 (A56)	Random Pad
039 (A57)	S/H Texture
040 (A58)	Warm Shimmer
041 (A61)	Nervous Pan
042 (A62)	JX - 3P Planet
043 (A63)	JX Melon Vox
044 (A64)	Horror Pad
045 (A65)	Shining Wave
046 (A66)	The Big Wave
047 (A67)	Mantrawave
048 (A68)	WavetablePan
049 (A71)	2.3 GlassSEQ
050 (A72)	VS Organbell
051 (A73)	DigitalChoir
052 (A74)	Additive
053 (A75)	Tower Silvis
054 (A76)	2.2 Rezdud
055 (A77)	Polysync
056 (A78)	Wavesync
057 (A81)	Rock Sync
058 (A82)	Kalimbasynt
059 (A83)	Stacc Heaven
060 (A84)	D50 Bellpad1
061 (A85)	D50 Bellpad2
062 (A86)	D50 Bellpad3
063 (A87)	Snow Lake
064 (A88)	Time flies

No.	Name
065 (B11)	Fanta - Retro
066 (B12)	SimpleEP+Pad
067 (B13)	Juno - 1 Bells
068 (B14)	Random Chime
069 (B15)	Asia Wave
070 (B16)	GoodniteBell
071 (B17)	2600 TRiBell
072 (B18)	Twinkle
073 (B21)	Analog Chime
074 (B22)	Space Echo
075 (B23)	Ethno Stack
076 (B24)	SH - 1000 MIDI
077 (B25)	ElectraPiano
078 (B26)	Rhodes Pad
079 (B27)	Sine Piano
080 (B28)	VCO Wurlly
081 (B31)	Clavipad
082 (B32)	P10 GuitClav
083 (B33)	Gum Clav
084 (B34)	JunoBiteClav
085 (B35)	Phazyn Clav
086 (B36)	JP - 8 Clav
087 (B37)	Alpha Clav
088 (B38)	Hyper Clav
089 (B41)	Perky Pad
090 (B42)	Perkolator
091 (B43)	MondoDiGiTaL
092 (B44)	Poly Flange
093 (B45)	and thenMIDI
094 (B46)	JP4Sharp Pad
095 (B47)	Splatly
096 (B48)	MKS80 Sprang
097 (B51)	JP8 Strings1
098 (B52)	JP8 Strings2
099 (B53)	JP+OB Strngs
100 (B54)	Wavestrings
101 (B55)	PWM Strings
102 (B56)	MemoryMG STR
103 (B57)	OB Thick Pad
104 (B58)	OB Soft Pad
105 (B61)	OctavaStrngs
106 (B62)	CS Saw Pad
107 (B63)	CS Strings
108 (B64)	Solina
109 (B85)	Rhapsody STR
110 (B66)	Big Strings
111 (B67)	Juno 106 Pad
112 (B68)	Majesty Pad
113 (B71)	Peaceful Pad
114 (B72)	Flange Strng
115 (B73)	JP SquarePad
116 (B74)	HollowBreath
117 (B75)	Hollow JX
118 (B76)	DarkEnsemble
119 (B77)	LonesomeHill
120 (B78)	VP - 330 Choir
121 (B81)	VP - 330 Tutti
122 (B82)	VP - 330 Sweep
123 (B83)	RS - 202 Brass
124 (B84)	Orchestrator
125 (B85)	OBJX Vox Pad
126 (B86)	Voices JX - 8P
127 (B87)	D50 Heavenly
128 (B88)	Mini Lead 1

No.	Name
129 (C11)	Mini Lead 2
130 (C12)	Pulse Lead
131 (C13)	Shmoog
132 (C14)	ClassicLead
133 (C15)	MG Swell
134 (C16)	MultiMG 5ths
135 (C17)	Sharp 5ths
136 (C18)	Retrosweep
137 (C21)	Velochord Ld
138 (C22)	Micro MG
139 (C23)	VCO Oct Lead
140 (C24)	ModularLead
141 (C25)	Expressolo
142 (C26)	Jupiter Lead
143 (C27)	GR500 SlowLd
144 (C28)	Pats GR - 300
145 (C31)	SH - 2000 Vox
146 (C32)	P5 Sync Lead
147 (C33)	Synkoid
148 (C34)	Promars Lead
149 (C35)	FM Lead
150 (C36)	CS Lead
151 (C37)	Wagnerian Ld
152 (C38)	Naked Cheese
153 (C41)	Telstar
154 (C42)	Limonaire
155 (C43)	Lucky Man
156 (C44)	OB 2 Voice
157 (C45)	Fue Pipe
158 (C46)	Living Calli
159 (C47)	Arpy Micro
160 (C48)	JP6 Bend 5th
161 (C51)	Happy Hollow
162 (C52)	Resotrails
163 (C53)	70s Sinusolo
164 (C54)	Alpha Lead
165 (C55)	Dark Brass
166 (C56)	Intervalead
167 (C57)	MG Beef Bass
168 (C58)	Monster MG
169 (C61)	Fat MG Bass
170 (C62)	Spike Bass
171 (C63)	ClassicMG Bs
172 (C64)	Reso MG Bass
173 (C65)	Wet MG Bass
174 (C66)	MG Ow Bass
175 (C67)	Rogue Bass
176 (C68)	MG Bs Pedals
177 (C71)	SH101 Zap Bs
178 (C72)	Bassic 101
179 (C73)	101 Oct Bass
180 (C74)	101 Ow Bass
181 (C75)	SH - 2 Bass
182 (C76)	JP - 4 Bass 1
183 (C77)	JP - 4 Bass 2
184 (C78)	System700 Bs1
185 (C81)	System700 Bs2
186 (C82)	TB303 AcidBs
187 (C83)	Talking Bs
188 (C84)	OB Bass
189 (C85)	2600 Reso Bs
190 (C86)	Odyssee Bs
191 (C87)	House Bass
192 (C88)	Wooler Bass

No.	Name
193 (D11)	Sharp Sub Bs
194 (D12)	Big Sub Bass
195 (D13)	Big Spike Bs
196 (D14)	System100 Bs
197 (D15)	Techno Bass
198 (D16)	Housine Bass
199 (D17)	Bark Bass
200 (D18)	Super Bass
201 (D21)	X Wire Bass
202 (D22)	T8 Sync
203 (D23)	P5 Sync Rush
204 (D24)	ArpeggiBs+12
205 (D25)	ArpeggiSaws
206 (D26)	Planet - S SEQ
207 (D27)	Synthacon
208 (D28)	Palpitating
209 (D31)	Descender
210 (D32)	Playmate
211 (D33)	MC8 Sequence
212 (D34)	Thips Blips
213 (D35)	Techno Perc
214 (D36)	Power B
215 (D37)	DirtyPurple
216 (D38)	Velo Rotary
217 (D41)	Gospel B
218 (D42)	Echo - Organ
219 (D43)	Organwave2.2
220 (D44)	VS Organ
221 (D45)	VK - 1 Organ
222 (D46)	Celesty Juno
223 (D47)	Alpharphisa
224 (D48)	Juno60 Organ
225 (D51)	JX - 8P Organ
226 (D52)	D - 50 Organ 1
227 (D53)	D - 50 Organ 2
228 (D54)	Are am eye?
229 (D55)	2600 Clk Org
230 (D56)	JX - 3P Pipes
231 (D57)	Tron Choir
232 (D58)	Misty Choir
233 (D61)	Tron Strings
234 (D62)	Melotron Pad
235 (D63)	Tape Echo
236 (D64)	StrawberyFit
237 (D65)	MellowFlutes
238 (D66)	Cyborg
239 (D67)	MKS80 Vortex
240 (D68)	Earthquake
241 (D71)	Dark Air
242 (D72)	Airdrome Pan
243 (D73)	Deep Wind
244 (D74)	Chronos
245 (D75)	Infinity
246 (D76)	Atmosphlange
247 (D77)	Medusa
248 (D78)	Aquaphone
249 (D81)	Computer Net
250 (D82)	Faveoravo
251 (D83)	Insecticide
252 (D84)	Off The Key
253 (D85)	H2O Asylum
254 (D86)	Aural Enigma
255 (D87)	RSS Spinner

■ Notes

When you create a Patch using the waveforms stored in the Expansion Board, observe the following points:

- If you make a Patch with a single voice and then later play it in a chord, the sound may be distorted under certain setting conditions of the Effects and TVA. If this happens, adjust the level of the Effects and TVA.
- Resonance may have already been set to On in some waveforms. If you try to add Resonance to such a waveform on the synthesizer, the sound may be distorted. If this happens, turn down the Resonance level.

■ ご注意

このエクステンション・ボードに収められているウェーブフォームを使ってパッチを作るときには、次の点に注意してください。

- 単音でパッチを作ったとき、エフェクトやTVAの設定状態によって、その音を和音で演奏すると音が歪む場合があります。このようなときは、エフェクトやTVAのレベルを調整してください。
- ウェーブフォームの中には、すでにレゾナンスのかかったものがあります。このウェーブフォームに本体で更にレゾナンスをかけたときは音が歪む場合があります。このようなときは、レゾナンス・レベルを下げてください。

WAVE LIST

No.	Name
001	JP - 8 Saw A
002	JP - 8 Saw C
003	Sys700 Saw
004	JX - 10 Saw
005	D - 50 Saw 1
006	D - 50 Saw 2
007	SH - 5 Saw
008	SH - 2 Saw
009	SH - 101 Saw
010	SH - 1000 Saw
011	GR - 300 Saw 1
012	GR - 300 Saw 2
013	JU - 2 Saw
014	MG Saw 1A
015	MG Saw 1C
016	MG Saw 2
017	OB Saw 1A
018	OB Saw 1C
019	OB Saw 2
020	P5 Saw 1A
021	P5 Saw 1C
022	2600 Saw
023	AP Saw
024	OSC Saw
025	OSC Reso Saw
026	KG700 Saw
027	KG800 Saw 1
028	KG800 Saw 2
029	KG MS Saw
030	CS Saw 1A
031	CS Saw 1
032	CS Saw 2
033	JP - 8 SquareA
034	JP - 8 SquareC
035	JX - 10 Square
036	SH - 5 Square
037	SH - 2 Square
038	MG Square A
039	MG Square C
040	OB Square A
041	OB Square C
042	P5 Square A
043	P5 Square C
044	2600 Square
045	OSC Square
046	KG800 Square
047	KG MS Square
048	CS Square
049	JP - 8 Pulse 1
050	JP - 8 Pulse 2
051	JP - 8 Pulse 3
052	JP - 8 Pulse 4
053	JP - 8 Pulse 5
054	SH - 1000 Puls
055	MG Pulse 1A

No.	Name
056	MG Pulse 1C
057	MG Pulse 2A
058	MG Pulse 2C
059	OB Pulse 1
060	OB Pulse 2
061	OB Pulse 3
062	2600 Pulse 1
063	2600 Pulse 2
064	EM Pulse
065	CS Pulse 1
066	CS Pulse 2
067	JU - 2 Sub OSC
068	MG Ramp
069	MG Triangle
070	2600Triangle
071	2600 Sine
072	JP - 8 PWM A
073	JP - 8 PWM B
074	JP - 8 PWM C
075	MG Dt.Saw A
076	MG Dt.Saw B
077	MG Dt.Saw C
078	P5 Dt.Saw A
079	P5 Dt.Saw B
080	P5 Dt.Saw C
081	MG Dt.Squ A
082	MG Dt.Squ B
083	MG Dt.Squ C
084	JP - 8 Str A
085	JP - 8 Str B
086	JP - 8 Str C
087	OB Str 1A
088	OB Str 1B
089	OB Str 1C
090	OB Str 2A
091	OB Str 2B
092	OB Str 2C
093	AP Str Ens A
094	AP Str Ens B
095	AP Str Ens C
096	OBXP Str A
097	OBXP Str B
098	OBXP Str C
099	OBXP Str Lp
100	MG Oct A
101	MG Oct B
102	MG Oct C
103	MG Dt.Oct A
104	MG Dt.Oct B
105	MG Dt.Oct C
106	OBXP Brass A
107	OBXP Brass B
108	OBXP Brass C
109	OBXP BrassLp
110	FM Brass

No.	Name
111	Waspy
112	Waspy Lp
113	OB Lead
114	OB Lead Lp
115	JP - 6 SqLead
116	JP - 6 SqLd Lp
117	Blown 1
118	Blown 2
119	PG Sweep 1A
120	PG Sweep 1C
121	PG Sweep 2A
122	PG Sweep 2C
123	D - 50 HeavenA
124	D - 50 HeavenB
125	D - 50 HeavenC
126	JX - 8P Vox
127	JX - 8P Vox Lp
128	VP - 330ChoirA
129	VP - 330ChoirB
130	VP - 330ChoirC
131	P5 Unisync
132	P5 UnisyncLp
133	P5 Dipthong
134	P5 DipthngLp
135	FM Lead
136	KG800 Lead
137	MG Lead
138	MG Lead Lp
139	JP - 8 Lead
140	Digiwave 1
141	Digiwave 2
142	Digiwave 3
143	Frog wave
144	SRG FM
145	Shimmer wave
146	VS Organ A
147	VS Organ C
148	Juno Organ
149	Juno OrganLp
150	FM Punch
151	Mondigital
152	MondigitalLp
153	JP - 8 Clavi A
154	JP - 8 Clavi C
155	JP - 8 ClaviLp
156	Juno Clavi
157	P5 X - mod
158	Steam Drum
159	Kalimba Aik
160	Additive
161	MG Blip
162	MG Blip Lp
163	MG Thump
164	MG Thump Lp
165	MG Attack

No.	Name
166	MG Attack Lp
167	VS Bell 1
168	VS Bell 2
169	JP - 6 Bell
170	MKS - 80 Xmod1
171	MKS - 80 Xmod2
172	MKS - 80 Xmod3
173	MKS - 80 Xmod4
174	MKS - 80 Xmod5
175	OB Bass
176	OB Bass Lp A
177	OB Bass Lp B
178	OB Bass Lp C
179	MG BsPedal
180	MG BsPdl LpA
181	MG BsPdl LpC
182	MG Fat Bs
183	MG Sharp Bs1
184	MG Big Bs
185	MG ClassicBs
186	MG Sharp Bs2
187	TB - 303 Bass
188	JP - 4 Bass 1
189	JP - 4 Bass 2
190	SH - 101 Bs 1
191	SH - 101 Bs 2
192	SH - 101 Bs 3
193	SH - 101 Bs 4
194	SH - 101 Bs 5
195	Sys700 Bs 1
196	Sys700 Bs 2
197	FM Super Bs
198	KG Poly Bs
199	KG Poly BsLp
200	Power B slwA
201	Power B slwB
202	Power B slwC
203	Power B 1stA
204	Power B 1stB
205	Power B 1stC
206	Tron Choir A
207	Tron Choir B
208	Tron Choir C
209	Tron Flute A
210	Tron Flute B
211	Tron Flute C
212	Tron Str A
213	Tron Str B
214	Tron Str C
215	MG White Nz
216	MG Pink Nz
217	SH - 5 Pink Nz
218	JP - 8 X - mod 1
219	JP - 8 X - mod 2
220	P5 Noise 1

No.	Name
221	P5 Noise 2
222	ZZZ loop
223	Atmosphere
224	FX1A - L(RSS)
225	FX1B - L(RSS)
226	FX1C - L(RSS)
227	FX1A - R(RSS)
228	FX1B - R(RSS)
229	FX1C - R(RSS)
230	FX2A - L(RSS)
231	FX2B - L(RSS)
232	FX2C - L(RSS)
233	FX2A - R(RSS)
234	FX2B - R(RSS)
235	FX2C - R(RSS)
236	FX3A - L(RSS)
237	FX3B - L(RSS)
238	FX3C - L(RSS)
239	FX3A - R(RSS)
240	FX3B - R(RSS)
241	FX3C - R(RSS)
242	REV Waspy
243	REV P5 X - mod
244	REV SteamDrn
245	REV Kalimba
246	REV Additive
247	REV Blip
248	REV Thump
249	REV Attack
250	REV FX1L RSS
251	REV FX1R RSS
252	REV FX2L RSS
253	REV FX2R RSS
254	REV FX3L RSS
255	REV FX3R RSS

Roland®

10850

UPC

10850



10850

Roland®