

Roland Sound Library

SR-JV80-05

"World" Expansion Board

Thank you for choosing the SR-JV80-05 Roland Sound Library "World Expansion" board.

- This expansion board provides 255 new Waveforms, and 255 Patches that employ the Waveforms on the expansion board as well as those on the main unit. The diverse collection of Waves that you now have at your disposal offers a wide variety of ethnic instruments, including percussion/rhythms, from all major regions of the world (Africa, Asia, Middle East, South America, North America, Australia, and Europe). Also included are phrases that employ the performance techniques used in these various cultures.
- One Rhythm Set is provided on the board. (Note: Can be used with the JV-1000 and JV-90.)

■ INSTALLING THE EXPANSION BOARD

* Turn off your instrument.

1. Remove the cover located on the bottom (or top) of your instrument.
2. Rotate the board holders so they align with the connector.
3. Mount the Expansion Board on the connector so the three board holders project through the Expansion Board.
4. Affix the Expansion Board by using the attached tool to turn the board holders in the LOCK direction.
(To remove the Expansion Board, turn the board holders in the UNLOCK direction and hook the board with the provided tool. Remove the board and secure the cover plate.)
5. Check if the Expansion Board is correctly installed.
If the "EXP" display is not selected (shown) in the Waveform Selection Screen (refer to the owner's manual of the instrument you use), remove the Expansion Board and install it properly.

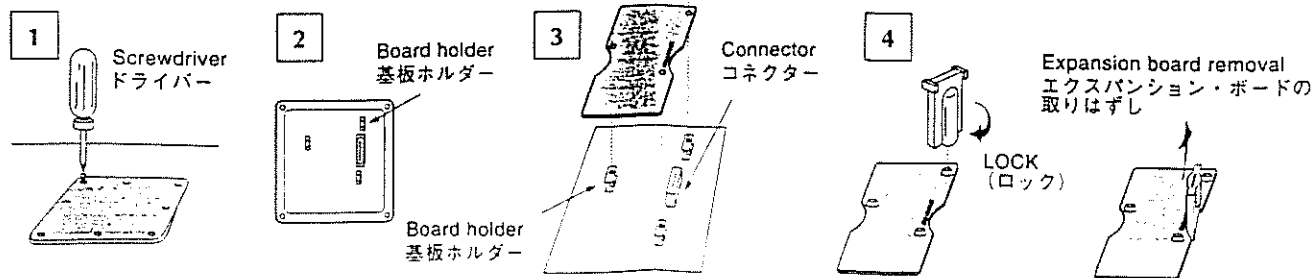

■ NOTE

When you use the Waveforms/Patches stored on the expansion board with the instrument other than the JV Series, those Waveforms/Patches may sound slightly different from those used with an JV unit. For a detailed explanation about this, read the owner's manual of the instrument you use.

Copyright © 1994 ROLAND CORPORATION
All rights reserved. No part of this publication may be reproduced in any form without the permission of ROLAND CORPORATION.
本書の一部、もしくは全部を無断で複写・転載することを禁じます。

このたびは、ローランド・サウンド・ライブラリーSR-JV80-05「ワールド・エクスパンション」をお買い上げいただきまして、まことにありがとうございます。

- このエクスパンション・ボードには、アフリカ、アジア、中近東、南米、北米、オーストラリア、ヨーロッパなど世界各地のパーカッション/リズム楽器を含めた民族楽器や、その奏法を含んだフレーズなど様々なウェーブフォームが255種類と、エクスパンション・ボードおよび本体のウェーブフォームを使用して作られたパッチが255種類記憶されています。
- リズム・セットが1種類記憶されています（注：JV-1000、JV-90で使用することができます）。

■ エクスパンション・ボードの取り付けかた

* 使用機器の電源スイッチをオフにしてください。

1. 使用機器の底部、または上部にあるカバーをはずします。
2. 基板ホルダーを、図2のような向きに合わせます。
3. エクスパンション・ボードのコネクタを、本体のコネクタに完全に差し込みます。このとき3つの基板ホルダーの頭が、エクスパンション・ボードから出るようにします。
4. 付属の固定用具で基板ホルダーをLOCK方向に回し、エクスパンション・ボードを固定します。
エクスパンション・ボードの取りはずしは、基板ホルダーをUNLOCK方向に回し、固定用具を引っかけて取りはずします。最後にカバーを取り付けます。
5. エクスパンション・ボードの取り付けが正しく行われたかを確認します。
ウェーブフォームの選択画面（使用機器の取扱説明書参照）で"EXP"が選べない（表示されない）ときは、もう一度エクスパンション・ボードをつけ直してください。

■ ご注意

JVシリーズ以外の機器でエクスパンション・ボードのウェーブフォーム/パッチを使用したときは、JVシリーズで使用したときの音色と多少異なる場合があります。詳しくは、使用機器の取扱説明書をご覧ください。

WAVE LIST

No.	Name	No.	Name	No.	Name	No.	Name	No.	Name
001	Sitar A	056	Hichiriki Lp	111	TablaBava Na	166	Tsuzumi Hi	221	Caixa Open2
002	Sitar B	057	Shahnai	112	TablaBavaTin	167	Ohkawa	222	Caixa Roll
003	Sitar C	058	Mizmar	113	TablaBavaTun	168	ChinaPrcMENU	223	Caixa Mute
004	Sitar Gliss	059	Mizmar Lp	114	TablaBava Te	169	Gu Roll	224	Agogo MENU
005	Tambura A	060	Piri	115	TablaBava Ti	170	Gu Hi	225	Agogo 2 Lo
006	Tambura B	061	Piri Lp	116	Udu Pot MENU	171	Rot Drum	226	Agogo 2 Hi
007	Tambura C	062	Steel Dr 2	117	Udu Pot1 Lo	172	BerimbauMENU	227	Agogo 3 Lo
008	TamburaDrone	063	Bonang	118	Udu Pot1 Hi	173	Berimbau Opn	228	Agogo 3 Hi
009	Zither A	064	Gender	119	Udu Pot1 Slp	174	Berimbau Up	229	Cowbell 1
010	Zither B	065	Saron	120	Udu Pot1 Acc	175	Berimbau Dn	230	Cowbell 2
011	Zither C	066	Blossom Bell	121	Udu Pot2 Lng	176	Berimbau Mut	231	Cowbell 3
012	HmrDulcimer	067	Spokes	122	Udu Pot2 Sht	177	Angklung 2	232	Cuica 2
013	Yuehchin	068	Satellite Dr	123	Udu Pot2 Mut	178	Afro Zither	233	Cuica 3
014	Yangchin	069	Finger Cym	124	Dholak MENU	179	JawHarp MENU	234	Shaker MENU
015	Bandolim	070	Ramacymbal	125	Dholak Ca	180	Jaw Harp Opn	235	Shaker Ptn
016	Cavaquinho	071	Atarigane	126	Dholak Ta	181	Jaw Harp Wow	236	Shaker 1
017	Oud A	072	AsiaGng MENU	127	Dholak Tun	182	Afro Feet 1	237	Shaker 2
018	Oud B	073	Asian Gong 1	128	Dholak Na	183	Afro Feet 2	238	Chekere 1
019	Oud C	074	Asian Gong 2	129	Madal MENU	184	Afro Clap	239	Chekere 2
020	Kanoun	075	Asian Gong 3	130	Madal Da	185	Rainstick	240	SambaWhistle
021	Koto	076	Asian Gong 4	131	Madal Din	186	Didge MENU	241	Guiro Long
022	Shamisen 2	077	Asian Gong 5	132	Madal Ta	187	Didgeridoo 1	242	Guiro Short
023	Shami Attack	078	Asian Gong 6	133	TalkingDr Up	188	Didgeridoo 2	243	Timbale MENU
024	Kayakeum	079	Asian Gong 7	134	TalkingDr Dn	189	Didgeridoo 3	244	Timbale Lo
025	Oct Harp	080	REV Gong 5	135	AfroDrm MENU	190	Voice MENU	245	Timbale Hi
026	Afro Harp	081	REV Gong 7	136	AfroDrm Op1	191	Yoh Tribe	246	Timbale Side
027	Biwa MENU	082	AsiaCym MENU	137	AfroDrm Op2	192	How Tribe	247	Bongo MENU
028	Biwa 1	083	Chenchen Ptn	138	AfroDrm Flm	193	Hey Brazil	248	Bongo 1 Lo
029	Biwa 2	084	Chenchen Opn	139	AfroDrm Rat	194	Yyoo Dude	249	Bongo 1 Hi
030	Biwa 3	085	Chenchen Cls	140	Tablah MENU	195	ZagrutaLoop	250	Bongo 2 Lo
031	Esraj 1	086	BaliCym Opn	141	Tablah Bend	196	ZagrutaStop	251	Bongo 2 Hi
032	Esraj 2	087	BaliCym Cls	142	Tablah Dom	197	Bull Scream	252	Korean Ens
033	Kemanche	088	Sagat Open	143	Tablah Tak	198	Conch Shell1	253	Morocco Ens
034	Erhu	089	Sagat Close	144	Tablah Rim	199	Conch Shell2	254	African Ens
035	Zampona 1	090	Sarna Bell	145	Tablah Roll	200	Samba MENU	255	World Tour
036	Zampo Attack	091	Kalimba 1	146	Doira Dun	201	SambaBateria		
037	Zampo Trem A	092	Kalimba 2	147	Doira Tik	202	PandeiroMENU		
038	Zampo Trem B	093	Kalimba 3	148	Doholla MENU	203	PandeiroL Lo		
039	Zampo Trem C	094	Kalimba Glis	149	Doholla Dom	204	PandeiroL Hi		
040	Sicu Pipe	095	Kalim Cls Lp	150	Doholla Sak	205	PandeiroL Sp		
041	Quena	096	Balaphone 1	151	Doholla Tak	206	PandeiroL Rm		
042	Ocarina	097	Balaphone 2	152	Doholla Roll	207	PandeiroS Op		
043	Kawala A	098	Log Drum 2	153	Doholla Stop	208	PandeiroS Sp		
044	Kawala B	099	Hyoshigi	154	Rek MENU	209	PandeiroS Rm		
045	Kawala C	100	Clapstick	155	Rek Dom	210	TamborimMENU		
046	Shakuhachi 2	101	Slit Drum	156	Rek Tek	211	Tamborim Opn		
047	Shaku Attack	102	Boomerang	157	Rek Open	212	Tamborim Mut		
048	Shaku Ornam	103	Ban Gu 1	158	Rek Trill	213	Tamborim Slp		
049	Hunt Pipe	104	Ban Gu 2	159	Bendir 1	214	Surdo MENU		
050	Hunt Noise	105	Ban Gu 3	160	Bendir 2	215	Surdo Open L		
051	Bagpipes 1	106	TablaBY MENU	161	Dawul	216	Surdo Open H		
052	Bagpipes 2	107	TablaBayaSlid	162	JapanPrcMENU	217	Surdo Mute		
053	Bagpipes 3	108	TablaBayaGin	163	Taiko	218	Surdo Rim		
054	Bagpipes 4	109	TablaBaya Ge	164	Sime Taiko	219	Caixa MENU		
055	Hichiriki	110	TablaBaya Ka	165	Tsuzumi Lo	220	Caixa Open1		

● With certain Waveforms, there are some restrictions as to the amount of pitch change available.

● When you create a Patch using the waveforms stored in the Expansion Board, observe the following points:

If you make a Patch with a single voice and then later play it in a chord, the sound may be distorted with certain settings for the Effects and TVA. If this happens, adjust the level of the Effects and TVA.

● ウェーブフォームによっては、ピッチの変化が制限されています。

● このエクspansion・ボードに収められているウェーブフォームを使ってパッチを作るときには、次の点に注意してください。

単音でパッチを作ったとき、エフェクトやTVAの設定状態によって、その音を和音で演奏すると音が歪む場合があります。このようなときは、エフェクトやTVAのレベルを調整してください。

WAVE LIST (BY REGION 地域別)

No.	Name	Category
-----	------	----------

South America (南米)		
233	Cuica 3	PRC
234	Shaker MENU	PRC:MENU
235	Shaker Ptn	PRC
236	Shaker 1	PRC
237	Shaker 2	PRC
238	Chekere 1	PRC
239	Chekere 2	PRC
240	SambaWhistle	PIPE
241	Guiro Long	PRC
242	Guiro Short	PRC
243	Timbale MENU	PRC:MENU
244	Timbale Lo	PRC
245	Timbale Hi	PRC
246	Timbale Side	PRC
247	Bongo MENU	PRC:MENU
248	Bongo 1 Lo	PRC
249	Bongo 1 Hi	PRC
250	Bongo 2 Lo	PRC
251	Bongo 2 Hi	PRC

Africa (アフリカ)

026	Afro Harp	HARP
049	Hunt Pipe	PIPE
050	Hunt Noise	PIPE
091	Kalimba 1	OTHR
092	Kalimba 2	OTHR
093	Kalimba 3	OTHR
094	Kalimba Glis	OTHR:FX
095	Kalim Gls Lp	OTHR:FX
096	Balaphone 1	MLT
097	Balaphone 2	MLT
098	Log Drum 2	PRC:MLT
101	Slit Drum	PRC:MLT
133	TalkingDr Up	PRC
134	TalkingDr Dn	PRC
135	AfroDrm MENU	PRC:MENU
136	AfroDrum Op1	PRC
137	AfroDrum Op2	PRC
138	AfroDrum Flm	PRC
139	AfroDrum Rat	PRC
178	Afro Zither	HARP
182	Afro Feet 1	PRC:FX
183	Afro Feet 2	PRC:FX
184	Afro Clap	PRC:FX
191	Yoh Tribe	VOX
192	How Tribe	VOX
254	African Ens	PHS

Southeast Asia (東南アジア)

063	Bonang	BEL
064	Gender	BEL
065	Saron	BEL
069	Finger Cym	CYM
070	Ramacymbal	CYM
083	Chenchen Ptn	CYM
084	Chenchen Opn	CYM
085	Chenchen Cls	CYM
086	BaliCym Opn	CYM
087	BaliCym Cls	CYM
177	Angklung 2	PRC
179	JawHarp MENU	PRC:MENU
180	Jaw Harp Opn	PRC
181	Jaw Harp Wow	PRC

No.	Name	Category
-----	------	----------

Australia (オーストラリア)		
100	Clapstick	PRC
102	Boomerang	PRC
186	Didge MENU	PIPE:FX:MENU
187	Didgeridoo 1	PIPE:FX
188	Didgeridoo 2	PIPE:FX
189	Didgeridoo 3	PIPE:FX

Others (その他)

066	Blossom Bell	BEL
067	Spokes	MLT
068	Satellite Dr	MLT
171	Rot Drum	PRC
190	Voice MENU	VOX:MENU
197	Bull Scream	VOX
198	Conch Shell1	PIPE:FX
199	Conch Shell2	PIPE:FX
255	World Tour	MENU

GTRGuitar-like instruments
 VLNViolin-like instruments
 HARPHarp-like instruments
 REEDReed instruments
 PIPEPipe & wind instruments
 MLTMallet instruments
 BELBell instruments
 CYMCymbal instruments
 GONGGong instruments
 PRCPercussive instruments
 OTHROther instruments
 VOXVoice (human)
 HMRStruck-string playing techniques
 FXSpecial playing techniques, effects
 REVReverse
 PHSPhrase
 MENUMenu
 (includes various instruments/techniques)

GTRギター系の楽器
 VLNバイオリン系の楽器
 HARPハープ系の楽器
 REEDリード系の楽器
 PIPEパイプ、ウインド系の楽器
 MLTマレット系の楽器
 BELベル系の楽器
 CYMシンバル系の楽器
 GONGゴング系の楽器
 PRCパーカッション楽器
 OTHRその他の楽器
 VOXボイス (声)
 HMR弦を叩く演奏法
 FX特殊な奏法、効果
 REVリバース
 PHSフレーズ
 MENUメニュー
 (いろいろな楽器、演奏方法を含んだもの)

PATCH LIST

No.	Name	No.	Name	No.	Name	No.	Name	No.	Name
001 (A11)	World Tour!	056 (A78)	Ring-RingPad	111 (B67)	Zampona tr 2	166 (C56)	ChineseOrch1	221 (D45)	Comb.Loop 5
002 (A12)	Afropunch	057 (A81)	Misterious	112 (B68)	Ethno Pipes1	167 (C57)	Mosque Reeds	222 (D46)	Comb.Loop 6
003 (A13)	Yo-How	058 (A82)	Re - mind	113 (B71)	Ethno Pipes2	168 (C58)	E.Com Lead 1	223 (D47)	Slow Loop 1
004 (A14)	Kenya Split	059 (A83)	Whistle Vox	114 (B72)	Ethno Pipes3	169 (C61)	Piri Solo	224 (D48)	2Bar Loop 1
005 (A15)	Intar Melody	060 (A84)	Living Dead	115 (B73)	Ocarina 3	170 (C62)	Mizmar	225 (D51)	2Bar Loop 2
006 (A16)	BerimbauMenu	061 (A85)	Earth Child	116 (B74)	Quena	171 (C63)	Shahnai	226 (D52)	2Bar Loop 3
007 (A17)	Thumb Chimes	062 (A86)	Spaceilimba	117 (B75)	Kawala	172 (C64)	Hichirick	227 (D53)	CylicSweep16
008 (A18)	Velo Afro 1	063 (A87)	Drop of Rain	118 (B76)	Kawallabe	173 (C65)	VeloBagpipes	228 (D54)	Special Loop
009 (A21)	Bass Kalimba	064 (A88)	Gaia Thought	119 (B77)	Romance Exp	174 (C66)	Bagpipes	229 (D55)	Samba Break/
010 (A22)	Buzz Kalimba	065 (B11)	Es E.Piano	120 (B78)	Wind 7 Split	175 (C67)	Dholla Menu	230 (D56)	Bushroot
011 (A23)	Indalimba	066 (B12)	Piri Rise	121 (B81)	Uni-Jig Pan	176 (C68)	Egypt Tablah	231 (D57)	Didgeridone
012 (A24)	Thumb Piano	067 (B13)	Pandoras Box	122 (B82)	OcarinaLead	177 (C71)	Madal Menu	232 (D58)	Didgeridone
013 (A25)	Kalimba FX	068 (B14)	Ethno Dreams	123 (B83)	Zamp Lead	178 (C72)	Dholak Menu	233 (D61)	Didgeridoo
014 (A26)	AfropercMenu	069 (B15)	Snow Man	124 (B84)	Blown Touch	179 (C73)	TablaProcess	234 (D62)	Paila MG
015 (A27)	Udu Pot Menu	070 (B16)	Cuica Steps	125 (B85)	Barkit	180 (C74)	Tinjaw	235 (D63)	Ethno Bass 1
016 (A28)	Udu Pots /	071 (B17)	Saintly	126 (B86)	Jungle Pipes	181 (C75)	Moroco FX	236 (D64)	Ethno Bass 2
017 (A31)	Baateri	072 (B18)	Trade Winds	127 (B87)	C Shell-echo	182 (C76)	Arabian	237 (D65)	Earth Com Bs
018 (A32)	Log Detuner	073 (B21)	Pure Logic	128 (B88)	Atmospluck	183 (C77)	TablanRhythm	238 (D66)	Clay HouseBs
019 (A33)	Afroperk	074 (B22)	Earth Color	129 (C11)	Airoharp Arq	184 (C78)	Tablafun	239 (D67)	Berimbass
020 (A34)	Glass Mallet	075 (B23)	jawbreath	130 (C12)	East/WestPlk	185 (C81)	Rattabla	240 (D68)	Hunter
021 (A35)	Velo Afro 2	076 (B24)	AsiaCYM Menu	131 (C13)	Koto	186 (C82)	Sitarchestra	241 (D71)	Jawskin
022 (A36)	Balafon /	077 (B25)	Gong Menu	132 (C14)	Zhueng	187 (C83)	Ravis Axe	242 (D72)	JawHarp Menu
023 (A37)	Hrd.Balafon	078 (B26)	Gong /	133 (C15)	Kotokeum	188 (C84)	Passag2India	243 (D73)	AfricaVoices
024 (A38)	Pure Balafon	079 (B27)	China Menu	134 (C16)	Kayakeum Plk	189 (C85)	Tambra Swirl	244 (D74)	Voice Set
025 (A41)	Big ole Logs	080 (B28)	Kabuki Menu	135 (C17)	Asian Dawn	190 (C86)	Sitar ++	245 (D75)	Zaghruta
026 (A42)	Afro Log	081 (B31)	Biwa	136 (C18)	Shamisen	191 (C87)	Movie Synth	246 (D76)	Maiting Call
027 (A43)	Angklungs	082 (B32)	Genderous	137 (C21)	Noo Tye Whan	192 (C88)	Sitarsqeezer	247 (D77)	Lost my way.
028 (A44)	BellAngklung	083 (B33)	Temple Metal	138 (C22)	Time Vault	193 (D11)	Sitar Gliss	248 (D78)	PlayLoHi F#m
029 (A45)	Steel Drums1	084 (B34)	Gomelan Tuti	139 (C23)	Airoharp 1	194 (D12)	Tambura	249 (D81)	Going Deep
030 (A46)	Steel Drums2	085 (B35)	African Snow	140 (C24)	OctHarp	195 (D13)	Tamb. Drone	250 (D82)	Worm Hole
031 (A47)	War Drums	086 (B36)	Bonang-Gam.	141 (C25)	ChineseOrch2	196 (D14)	Breath Drum	251 (D83)	Ethno Splash
032 (A48)	AfricanMarch	087 (B37)	Gamelan x4	142 (C26)	Euro Zither	197 (D15)	Tribe Switch	252 (D84)	DinosaurPark
033 (A51)	AfricanStomp	088 (B38)	Saron-Gameln	143 (C27)	AfricaZither	198 (D16)	Perc. Hit 1	253 (D85)	BackwardGong
034 (A52)	Tribal Claps	089 (B41)	Temple Chime	144 (C28)	Zithgliss	199 (D17)	Perc. Hit 2	254 (D86)	AfricanQueen
035 (A53)	Kawala Str	090 (B42)	Prayer Bowls	145 (C31)	Hmr.Dulcimer	200 (D18)	Big Perc.Hit	255 (D87)	BedRock 5.30
036 (A54)	Space-o-rama	091 (B43)	Hiten Bells	146 (C32)	Cymbalom	201 (D21)	Doira Drum		
037 (A55)	Shakupad	092 (B44)	Trash Metal	147 (C33)	Brt.Dulcimer	202 (D22)	Bendir		
038 (A56)	Ceremony	093 (B45)	Singing Bell	148 (C34)	Yangchin 1	203 (D23)	Chekere /		
039 (A57)	Los Tremolos	094 (B46)	Rama Chimes	149 (C35)	EasternTwang	204 (D24)	Rek Menu		
040 (A58)	Lo Celloez	095 (B47)	Rama Cymbals	150 (C36)	12th Knight	205 (D25)	Shaker Menu		
041 (A61)	Octargans	096 (B48)	Tibet Bells	151 (C37)	Bandolim	206 (D26)	Caixa Menu		
042 (A62)	Lo Ethnoreed	097 (B51)	Big Bowls	152 (C38)	Cavaquinho	207 (D27)	Cowbell Menu		
043 (A63)	Eastvox	098 (B52)	Spoke Mallet	153 (C41)	Oud	208 (D28)	Bongo Set		
044 (A64)	Black Rain	099 (B53)	Shakuhachi	154 (C42)	Mondo Oud!	209 (D31)	Guiro /		
045 (A65)	Steel 5th	100 (B54)	Shaku Accent	155 (C43)	HybridStrung	210 (D32)	Samba Menu		
046 (A66)	5th Wind	101 (B55)	Shakueko	156 (C44)	GlobalChorus	211 (D33)	Pandeiro Menu		
047 (A67)	5th Bell	102 (B56)	Pipe Melodi	157 (C45)	Kanoum	212 (D34)	Surdo Menu		
048 (A68)	Ocarawla	103 (B57)	Flautwist	158 (C46)	MultieastPix	213 (D35)	Cuica		
049 (A71)	Conch Call	104 (B58)	Flute Press	159 (C47)	Yuehchin	214 (D36)	Rain Stick		
050 (A72)	Sweep Floop	105 (B61)	Zamponia	160 (C48)	Crossbreed	215 (D37)	Rotating Drm		
051 (A73)	Space Pipe	106 (B62)	Wosh Chiff	161 (C51)	SoftRezituar	216 (D38)	BellsOfSarna		
052 (A74)	PercssivRain	107 (B63)	Tramaloo	162 (C52)	Ethnic VLNx3	217 (D41)	Comb.Loop 1		
053 (A75)	Asian Chord	108 (B64)	FantasicPipe	163 (C53)	Singil Piper	218 (D42)	Comb.Loop 2		
054 (A76)	Dell Ikhiit	109 (B65)	Pan Pipe /	164 (C54)	Kulture Shok	219 (D43)	Comb.Loop 3		
055 (A77)	Ghost Metal	110 (B66)	Random Zamp	165 (C55)	Erhu Lead	220 (D44)	Comb.Loop 4		

● To use Patch data stored in the Expansion Board, load the relevant Patch data according to the owner's manual of the instrument being used.

● Patches in the above Patch List that include the word "Loop" in their name use Waveforms which employ phrase looping. When using such Patches, it is best to play them using the C4 key. (If some of these Patches are played on keys on the keyboard which are relatively distant from C4, you could encounter problems (such as with the timing).

● エクスパンション・ボードのパッチを使うときは、使用機器の取扱説明書にしたがって、パッチのロードを実行してください。

● パッチ・リストの中で、名前の一部に"Loop"と付いているパッチはフレーズ・ループのウェーブフォームを使用しています。このパッチを使うときは、C4で演奏することをお奨めします。(パッチによってはC4から大きく離れた鍵盤で演奏するとタイミング等のずれを生じるものがあります。)

WAVE LIST (BY REGION 地域別)

No.	Name	Category
India (インド)		
001	Sitar A	GTR
002	Sitar B	GTR
003	Sitar C	GTR
004	Sitar Gliss	GTR:FX
005	Tambura A	GTR
006	Tambura B	GTR
007	Tambura C	GTR
008	TamburaDrone	GTR:FX
031	Esraj 1	VLN
032	Esraj 2	VLN
057	Shahnai	REED
090	Sarna Bell	BEL
106	TablaBY MENU	PRC:MENU
107	TablaBayaSid	PRC
108	TablaBayaGin	PRC
109	TablaBayaGe	PRC
110	TablaBayaKa	PRC
111	TablaBayaNa	PRC
112	TablaBayaTin	PRC
113	TablaBayaTun	PRC
114	TablaBayaTe	PRC
115	TablaBayaTi	PRC
116	Udu Pot MENU	PRC:MENU
117	Udu Pot1 Lo	PRC
118	Udu Pot1 Hi	PRC
119	Udu Pot1 Slip	PRC
120	Udu Pot1 Acc	PRC
121	Udu Pot2 Lng	PRC
122	Udu Pot2 Sht	PRC
123	Udu Pot2 Mut	PRC
124	Dholak MENU	PRC:MENU
125	Dholak Ga	PRC
126	Dholak Ta	PRC
127	Dholak Tun	PRC
128	Dholak Na	PRC
129	Madal MENU	PRC:MENU
130	Madal Da	PRC
131	Madal Din	PRC
132	Madal Ta	PRC
Middle East (中近東)		
017	Oud A	GTR
018	Oud B	GTR
019	Oud C	GTR
020	Kanoun	GTR
033	Kemanche	VLN
043	Kawala A	PIPE
044	Kawala B	PIPE
045	Kawala C	PIPE
058	Mizmar	REED
059	Mizmar Lp	REED
088	Sagat Open	CYM
089	Sagat Close	CYM
140	Tablah MENU	PRC:MENU
141	Tablah Bend	PRC
142	Tablah Dom	PRC
143	Tablah Tak	PRC
144	Tablah Rim	PRC
145	Tablah Roll	PRC
146	Doira Dun	PRC
147	Doira Tik	PRC
148	Doholla MENU	PRC:MENU
149	Doholla Dom	PRC
150	Doholla Sak	PRC
151	Doholla Tak	PRC

No.	Name	Category
152	Doholla Roll	PRC
153	Doholla Stop	PRC
154	Rek MENU	PRC:MENU
155	Rek Dom	PRC
156	Rek Tek	PRC
157	Rek Open	PRC
158	Rek Trill	PRC
159	Bendir 1	PRC
160	Bendir 2	PRC
161	Dawul	PRC
195	ZaghrutaLoop	VOX
196	ZaghrutaStop	VOX
253	Morocco Ens	PHS
Japan (日本)		
021	Koto	GTR
022	Shamisen 2	GTR
023	Shami Attack	GTR
027	Biwa MENU	GTR:MENU
028	Biwa 1	GTR
029	Biwa 2	GTR
030	Biwa 3	GTR
046	Shakuhachi 2	PIPE
047	Shaku Attack	PIPE
048	Shaku Ornam	PIPE
055	Hichiriki	REED
056	Hichiriki Lp	REED
071	Atarigane	PRC:BEL
099	Hyoshigi	PRC
162	JapanPrcMENU	PRC:MENU
163	Taiko	PRC
164	Sime Taiko	PRC
165	Tsuzumi Lo	PRC
166	Tsuzumi Hi	PRC
167	Ohkawa	PRC
194	Yyoo Dude	VOX
Korea (韓国)		
024	Kayakeum	GTR
060	Piri	REED
061	Piri Lp	REED
252	Korean Ens	PHS
China (中国)		
013	Yuehchin	GTR
014	Yangchin	GTR:HMR
034	Erhu	VLN
072	AsiaGng MENU	GONG:MENU
073	Asian Gong 1	GONG
074	Asian Gong 2	GONG
075	Asian Gong 3	GONG
076	Asian Gong 4	GONG
077	Asian Gong 5	GONG
078	Asian Gong 6	GONG
079	Asian Gong 7	GONG
080	REV Gong 5	GONG:REV
081	REV Gong 7	GONG:REV
082	AsiaCym MENU	CYM:MENU
103	Ban Gu 1	PRC
104	Ban Gu 2	PRC
105	Ban Gu 3	PRC
168	ChinaPrcMENU	PRC:MENU
169	Gu Roll	PRC
170	Gu Hi	PRC

No.	Name	Category
Europe (ヨーロッパ)		
009	Zither A	GTR
010	Zither B	GTR
011	Zither C	GTR
042	Ocarina	PIPE
051	Bagpipes 1	REED
052	Bagpipes 2	REED
053	Bagpipes 3	REED
054	Bagpipes 4	REED
North America (北米)		
012	HmrDulcimer	GTR:HMR
South America (南米)		
015	Bandolim	GTR
016	Cavaquinho	GTR
025	Oct Harp	HARP
035	Zampona 1	PIPE
036	Zampo Attack	PIPE
037	Zampo Trem A	PIPE
038	Zampo Trem B	PIPE
039	Zampo Trem C	PIPE
040	Sicu Pipe	PIPE
041	Quena	PIPE
062	Steel Dr 2	MLT
172	BerimbauMENU	PRC:GTR:HMR:MENU
173	Berimbau Opn	PRC:GTR:HMR
174	Berimbau Up	PRC:GTR:HMR
175	Berimbau Dn	PRC:GTR:HMR
176	Berimbau Mut	PRC:GTR:HMR
185	Rainstick	PRC
193	Hey Brazil	VOX
200	Samba MENU	PHS:MENU
201	SambaBateria	PRC
202	PandeiroMENU	PRC:MENU
203	PandeiroL Lo	PRC
204	PandeiroL Hi	PRC
205	PandeiroL Sp	PRC
206	PandeiroL Rm	PRC
207	PandeiroS Op	PRC
208	PandeiroS Sp	PRC
209	PandeiroS Rm	PRC
210	TamborimMENU	PRC:MENU
211	Tamborim Opn	PRC
212	Tamborim Mut	PRC
213	Tamborim Slip	PRC
214	Surdo MENU	PRC:MENU
215	Surdo Open L	PRC
216	Surdo Open H	PRC
217	Surdo Mute	PRC
218	Surdo Rim	PRC
219	Caixa MENU	PRC:MENU
220	Caixa Open1	PRC
221	Caixa Open2	PRC
222	Caixa Roll	PRC
223	Caixa Mute	PRC
224	Agogo MENU	BEL:MENU
225	Agogo 2 Lo	BEL
226	Agogo 2 Hi	BEL
227	Agogo 3 Lo	BEL
228	Agogo 3 Hi	BEL
229	Cowbell 1	BEL
230	Cowbell 2	BEL
231	Cowbell 3	BEL
232	Caixa 2	PRC

RHYTHM SET

	Note No.	Used Waveform No.	Name
C2	36	215	Surdo Open L
	37	217	Surdo Mute
	38	203	PandeiroL Lo
	39	206	PandeiroL Rm
	40	211	Tamborim Opn
	41	220	Caixa Open1
	42	222	Caixa Roll
	43	244	Timbale Lo
	44	246	Timbale Side
	45	245	Timbale Hi
C3	46	238	Chekere 1
	47	248	Bongo 1 Lo
	48	249	Bongo 1 Hi
	49	236	Shaker 1
	50	225	Agogo 2 Lo
	51	237	Shaker 2
	52	226	Agogo 2 Hi
	53	230	Cowbell 2
	54	232	Cuica 2
	55	241	Guiro Long
C4	56	240	SambaWhistle
	57	242	Guiro Short
	58	073	Asian Gong 1
	59	076	Asian Gong 4
	60	077	Asian Gong 5
	61	084	Chenchen Opn
	62	079	Asian Gong 7
	63	085	Chenchen Cts
	64	103	Ban Gu 1
	65	105	Ban Gu 3
C5	66	070	Ramacymbal
	67	117	Udu Pot1 Lo
	68	123	Udu Pot2 Mut
	69	121	Udu Pot2 Lng
	70	107	TablaBayaSkd
	71	109	TablaBaya Ge
	72	110	TablaBaya Ka
	73	111	TablaBaya Na
	74	112	TablaBayaTin
	75	155	Rek Dom
C6	76	156	Rek Tek
	77	157	Rek Open
	78	158	Rek Tril
	79	160	Bendir 2
	80	088	Sagat Open
	81	089	Sagat Close
	82	098	Log Drum 2
	83	101	Sit Drum
	84	134	TalkingDr Dn
	85	182	Afro Feet 1
C7	86	139	AfroDrum Flat
	87	184	Afro Clap
	88	173	Berimbau Opn
	89	176	Berimbau Mut
	90	165	Tsuzumi Lo
	91	164	Sime Taiko
	92	166	Tsuzumi Hi
	93	099	HyoShigi
	94	187	Didgeridoo 1
	95	100	Clapstick
96	102	Boomerang	

● The Rhythm Sets in this expansion board cannot be used with the JV-80/880 or JD-990.

● In order to play Rhythm Sets on the JV-90/1000, you need to select the Rhythm Set for the Rhythm Part in the Performance mode, then use the buttons for the Rhythm mode to play the sounds.

● JV-80/880, JD-990では、エクステンション・ボードのリズム・セットを使用することはできません。

● JV-90/1000でリズム・セットを演奏するときは、パフォーマンス・モードのリズム・パートでリズム・セットを選択した後、リズム・モードのボタンを押して演奏してください。

 Roland®

10848

UPC 10848



10848