



Versatile, Portable PA with a Twist

The unique BA-55 provides self-contained, high-quality, and battery-powered sound reinforcement for any environment. It's solidly built yet lightweight, and comes bundled with a matching wireless microphone for public speaking, singing, and many other events. Use the BA-55 as a small wireless PA system in school classrooms, business meetings, restaurants, weddings, intimate music venues, and more. In a cool and convenient twist, the BA-55 contains an internal accelerometer sensor that automatically switches operation between stereo output (when positioned horizontally) and mono output (when positioned vertically). If you're speaking and need maximum power and projection, use the vertical mono mode. For wide musical spread, turn horizontal. It's that easy! The BA-55 is available in two color choices, black (BA-55) or white (BA-55-WH). Choose one of these classic colors to blend best with your surroundings.



Included wireless mic: DR-WM55

- ▶ Portable design with high-quality sound for audiences up to 80 people
- ▶ SPL (sound pressure level) rated at a powerful 108 dB
- ▶ One 2.4 GHz wireless microphone included (DR-WM55); a second DR-WM55 can be purchased separately for simultaneous use
- ▶ Operates on 8 AA batteries or AC power (AC adaptor included)
- ▶ Onboard accelerometer sensor switches operation to stereo mode when positioned horizontally
- ▶ Two 6.5" (16 cm) high-performance speakers
- ▶ Three-channel built-in mixer with two-band EQ
- ▶ Echo/Reverb effect
- ▶ Built-in Anti-Feedback function
- ▶ Line Output for recording or expanding the system
- ▶ Integrated storage compartment for storing wireless microphones and accessories
- ▶ Auto Power Off function
- ▶ Compatible with Roland ST-A95 speaker stand

Easy to Use and Transport

With the BA-55, ease of use is the name of the game. There's nothing complicated about it: just turn on the wireless microphone and/or plug in your instruments, set the volume to the desired level, and go. That's it! The BA-55's automatic anti-feedback system blocks acoustic feedback without interrupting your audio. For easy transport, the BA-55 has a convenient built-in storage compartment to house your wireless microphones and accessories.

Multi-Purpose PA

The BA-55 lets you enjoy great sound anywhere, indoors or outdoors. Use batteries or the included AC adapter for the ultimate in convenience and flexibility— For speech, position the BA-55 vertically and the internal accelerometer will automatically switch operation to mono mode for maximum sound projection. For music, place the BA-55 horizontally and it will automatically switch to stereo mode; this is perfect when using MP3/CD players at dance parties, etc., or any application where wide sound projection is desired.

Built-In Echo/Reverb

Onboard the BA-55 is an Echo/Reverb that sounds great and is easy to use, with a single knob that adjusts both the effect type and amount. When you turn the knob from the Off position to 12 o'clock, you activate a natural plate-reverb-type effect that adds a natural ambience to your voice and/or instruments. When you turn from the 12 o'clock position to maximum, you switch to a repetitive echo-type effect. The echo/reverb can also be turned on and off from the included DR-WM55 wireless microphone for convenient remote control (see below).

Wireless Microphone Included

The BA-55 package includes a high-quality wireless microphone (DR-WM55). Designed specifically for this system, the mic has Power On/Off and Echo On/Off switches. The Echo switch is linked to the BA-55's Echo/Reverb effect, which lets you enable and disable it directly from the mic. This is a very handy feature, allowing the effect to be quickly turned off when speaking or making announcements, then easily switched back on for singing.

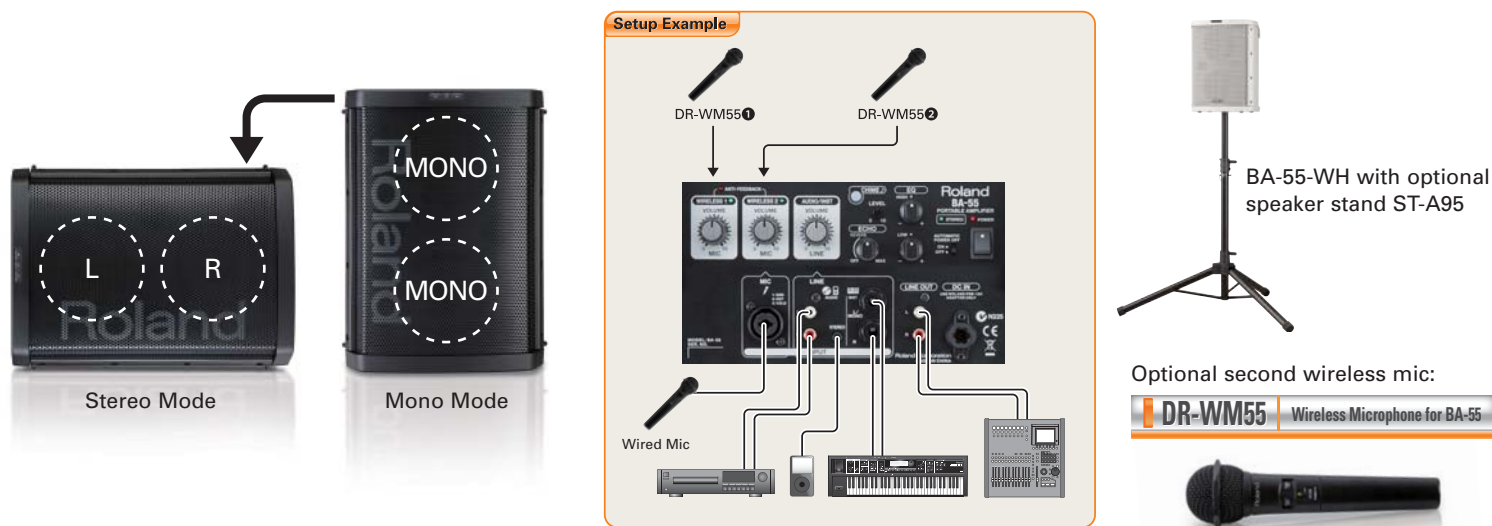

BA-55 Specifications

■ **Rated Power Output** 20 W, SPL: 108 dB ■ **Nominal Input Level** (1 kHz) CH2 MIC (XLR type): -50 dBu, AUDIO/INST (RCA phono type): -10 dBu, AUDIO/INST (Stereo miniature phone type, 1/4" phone type): -20 dBu ■ **Nominal Output Level** (1 kHz) LINE OUT: -10 dBu ■ **Speakers** 16 cm (6.5 inches) x 2
 ■ **Wireless Reception Method** Roland Original (for only DR-WM55) ■ **Controls** [POWER Switch], [Channel Controls] Wireless 1, Wireless 2: VOLUME Knob, AUDIO/INST: VOLUME Knob, [CHIME Button], [CHIME VOLUME Knob], [ECHO Knob], [Master Controls] Equalizer: HIGH Knob, LOW Knob, [AUTO POWER OFF Switch] ■ **Indicator** PANEL: WIRELESS 1, WIRELESS 2, ANTI-FEEDBACK, STEREO, POWER, FRONT: WIRELESS 1, WIRELESS 2, POWER ■ **Connectors** MIC: Input jacks (XLR type, 1/4" TRS phone type) AUDIO/INST: Input jacks (Stereo miniature phone type, RCA phono type), INST Input jack L/MONO (1/4"

phone type), INST Input jack R (1/4" phone type), OUTPUT: LINE OUT jack (RCA phono type), DC IN: DC IN jack ■ **Power Supply** DC 12 V: Alkaline battery (AA, LR6) x 8, Rechargeable Ni-MH battery (AA, HR6) x 8, AC Adaptor ■ **Current Draw** 430 mA ■ **Expected battery life** under continuous use: Alkaline battery (AA, LR6): about 6 hours, Rechargeable Ni-MH battery (AA, HR6): about 6 hours *These figures will vary depending on the actual conditions of use. ■ **Dimensions** 355 (W) x 265 (D) x 481 (H) mm / 14 (W) x 10-7/16 (D) x 18-15/16 (H) inches ■ **Weight** 9 kg / 19 lbs 14 oz (Excluding Battery) ■ **Included Accessories** Wireless MIC (DR-WM55) x 1, Power Cord, AC Adaptor, Owner's Manual ■ **Options** Speaker Stand (ST-A95), Wireless MIC (DR-WM55)

*0 dBu = 0.775 Vrms

DR-WM55 Specifications

■ **Element Dynamic** ■ **Polar Pattern** Uni Directional ■ **Maximum Input S.P.L.** 124 dB SPL (3% THD at 1 kHz) ■ **RF carrier frequency** 2.4 GHz (ISM Band) ■ **Wireless Transmission method** Roland Original ■ **Transmission Power** 10 mW ■ **Antenna** built-in Antenna ■ **Outreach** line-of-sight 20 m (This figure will vary depending on the actual conditions of use and the environment.) ■ **Indicator** POWER ■ **Controls** [Power] switch, [ECHO ON] switch, [Echo Off] switch ■ **Power Supply** DC 3 V, Alkaline battery (AA, LR6) x 2, Rechargeable

Ni-MH battery (AA, HR6) x 2 ■ **Expected battery life** under continuous use Alkaline battery: approximately 24 hours, Rechargeable Ni-MH battery: about 24 hours * These figures will vary depending on the actual conditions of use. ■ **Dimensions** 59 (W) x 214 (H) mm / 2-3/8 x 8-7/16 inches ■ **Weight** 164 g / 6 oz ■ **Included Accessories** Owner's Manual, Microphone Holder, Alkaline battery (AA, LR6) x 2

* The specifications are subject to change without notice.