

Roland

# *CD-2i* SD/CD RECORDER

High-Quality Recording Direct to Disc



Record Listen Burn CDs

# Effortless CD Burning and more!



## CD-2i SD/CD RECORDER



\* 32 GB Card not supported



## Record

With the CD-2i, everything is self-contained. Recording is fast, friendly, and super convenient.

STEP 1

Select the media to be used for recording.

Press the [CD] button or [SD CARD].

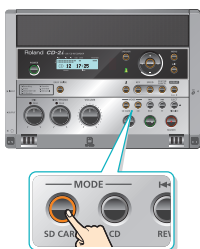

STEP 2

Adjust the input level of the internal mics.

Set the [MIC LEVEL] switch to the MANUAL position and turn the [MIC] knob to adjust the input level of the internal mics.

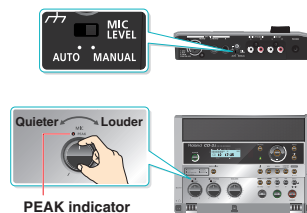

STEP 3

Let's start recording!

Press the [●] (Record) button to enter record-standby mode. Press the [▶] (Play) button to begin recording.

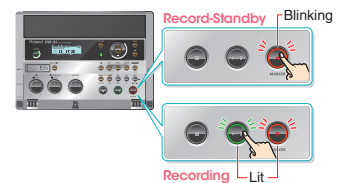

### Transfer and archive your favorite records to CDs

The CD-2i is equipped with a phono-equalizer and can be connected to a record player directly. You can transfer your favorite records to CDs with ease, preserving them for generations to come.



### Connecting an External Mic

The CD-2i supports condenser mics that require phantom power (DC48V, 10 mA Max).

\* The included AC adaptor is required if you're using phantom power.







# Listen

Helpful features for musical training.



More than just a great recorder, the CD-2i has useful functions for music students. You can loop specific sections of audio for repetitive study. You can change key and tempo; decrease the tempo, for example, without changing pitch to learn tricky sections of songs.

<b>KEY</b>	Adjusts the key (pitch) of playback in semitone steps.
<b>PITCH</b>	Adjusts the pitch of playback in one-cent steps. You can adjust the CD playback pitch to perfectly match your instrument.
<b>SPEED</b>	Without altering the pitch, the playback speed can be changed. <b>TAPE MODE</b> Changing the playback speed will affect the pitch, just as it would for tape playback. If you're trying to hear how words are being pronounced.
<b>CENTER CANCEL</b>	This function cancels the portion of the sound in the center of the stereo image, such as the lead vocal or guitar, making it less audible.
<b>A-B Repeat</b>	Only a selected part of the song is played back. It's convenient when you're practicing your instrument along with songs, or learning languages.

\* The Center Cancel function cannot completely erase the vocals or guitar solos.



# Burn CDs

It's easy to burn CDs!

The CD-2i simplifies the process without sacrificing quality.

STEP 1

## Select the Menu

Press the [MENU] button to access the menu screen, and choose "Write (SD→CD) ?"



CD-R/RW  
Write (SD→CD) ?

STEP 2

## Insert a CD-R/RW Disc

Insert a CD-R/RW Disc  
Insert a blank CD-R/RW disc to burn your music onto.



STEP 3

## Select Songs

Select songs that you want to burn to CD and follow the simple onscreen instructions. Your CD is done!



Finalize :Ves

A music disc is finalized.



# EASY GUIDE

Easy Guide is a convenient function that lets you operate the CD-2i simply by following the onscreen instructions. No owner's manual required!

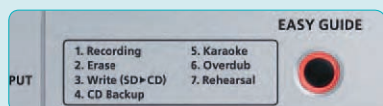

## Rehearsal function sets the perfect levels for your recording

Since the CD-2i can automatically adjust the input level using its Rehearsal function, anyone can make high-quality recordings.



Rehearsal Function Screen

## EASY GUIDE Menu List

<b>1. Recording</b>	Record a vocal or instrumental performance to either an SD memory card or a CD-R/RW disc.
<b>2. Erase</b>	Erase a track on either an SD memory card or a CD-RW disc.
<b>3. Write (SD→CD)</b>	Create a music CD by writing tracks from an SD memory card to a CD-R/RW disc.
<b>4. CD Backup</b>	Make a backup of your original-music CD.
<b>5. Karaoke</b>	While playing back a music CD you can add your own vocal, and record the combined result onto an SD memory card.
<b>6. Overdub</b>	While playing back a previously recorded performance from an SD memory card, you can layer (overdub) another vocal or instrumental performance and record the combined result to a new track.
<b>7. Rehearsal</b>	Automatically sets the optimal input level while you rehearse your performance.

## Slim and lightweight body

The CD-2i weighs only 1.3 kg (2lbs 13 oz.) and comes in a slim enclosure that's a mere 5cm (2 inches) thick. It's stylish and functional — position it anywhere you like.

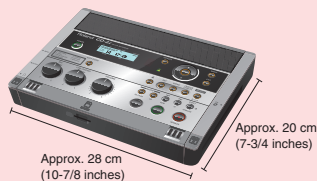

## Supports AC and battery power

Power the CD-2i from an AC adaptor or batteries. Take it anywhere!



\* For performing CD-related operations such as recording, playing, or writing songs, use the included AC adaptor.

## Useful features

The CD-2i comes with a compact wireless remote control. You can perform recording operations without moving away from your instrument.



## Music-Practice Partner

The built-in Tuner and Metronome functions are useful for practice and performance.

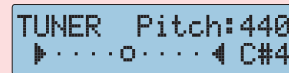

Tuner Function Screen

## TOP PANEL

### Stereo Speakers

### EASY GUIDE Button

### Input level / Volume Knob

### SD Card Slot

### Stereo Microphones

### Metronome Button & Play Mode Buttons

### CD Tray

### SD/CD Operation Buttons

## REAR PANEL

### External Mic Jacks (L/MONO)/R



Stereo Mics

### Line/Phono In Jacks (L/R)



### External Mic Jack (XLR)



Dynamic Mic



Condenser Mic

### Line Out Jacks (L/R)



Powered Speakers

### Headphone Jack



Headphones

## CD-2i SPECIFICATIONS

Recorder Part			
Tracks	2 (Stereo)		
Sampling Rate	44.1 kHz		
Signal Processing	AD/DA conversion: 24 bits		
Recording Mode	SD Memory Card: WAV (44.1 kHz, 16 bits) CD-R, CD-RW: Audio CD		
Recording Media	SD Memory Card (supports 64 MB to 16 GB, SDHC format compatible) *32 GB Card not supported, CD-R, CD-RW		
Recording Time	■ CD-R or CD-RW disc		■ SD Memory Card
	Disc Capacity	Recording Time	Card Capacity
	650 MB	74 min	64 MB
	700 MB	80 min	128 MB
Recording Time	* Each recording time is an approximate estimate including some errors. * In case that there are plural files, the sum of recording time would be shorter. * Maximum recording time of one song is 74 minutes.		Recording Time
			64 MB
			128 MB
			256 MB
Recording Time			512 MB
			1 GB
			2 GB
			4 GB
Recording Time			8 GB
			16 GB
			1511 min
Recording Songs	Up to 99 songs on a single SD Memory Card, CD-R, or CD-RW		

Input/Output	
Audio Input	Internal Stereo Microphones EXT MIC (L/MONO, R) Jacks: 1/4 inch phone type EXT MIC (MONO) Jack: XLR type (phantom power: DC 48 V, 10 mA Max) LINE/PHONO (L, R) Jacks: RCA phono type
Audio Output	Internal Stereo Speakers LINE OUT Jacks: RCA phono type PHONES Jack: Stereo miniatur phone type
Frequency Response	20 Hz to 20 kHz (+0dB/-2dB)
Nominal Input Level (variable)	EXT MIC (L/MONO, R) Jacks: -51 to -14 dBu EXT MIC (MONO) Jack: -51 to -14 dBu LINE/PHONO (L, R) Jacks: -24 to 0 dBu (LINE) / -55 to -30 dBu (PHONO)
Nominal Output Level	LINE OUT Jacks: -10 dBu
Input Impedance	EXT MIC (L/MONO, R) Jacks: 20 k ohms EXT MIC (MONO) Jack: 10 k ohms LINE/PHONO (L, R) Jacks: 9 k ohms (LINE) / 50 k ohms (PHONO)
Output Impedance	LINE OUT Jacks: 1 k ohms, PHONES Jack: 32 ohms

Other	
Display	16 characters, two lines (backlit LCD)
Dimensions	mm: 275.3 (W) x 195.9 (D) x 49.8 (H) inches: 10-7/8 (W) x 7-3/4 (D) x 2 (H)
Weight	1.27 kg / 2 lbs. 13 oz.
Power Supply	AC Adaptor, AA type Alkaline dry battery (LR6) x 6 or Nickel-metal hydride battery (HR15/51) x 6
Current Draw	800 mA
Expected battery life under continuous use	Alkaline dry batteries: approximately 5 hours Nickel-metal hydride batteries: approximately 6 hours * The time may vary according to usage conditions, batteries used, and type of SD memory card used.
Accessories	Owner's Manual, Quick Start, Remote Controller (with Battery CR2025), AC Adaptor, Power Cord (for AC Adaptor), SD Memory Card, CD-R Disc (Blank media), SD Card Protector

(0 dBu = 0.775 V rms)

\*Recording, duplication, distribution, sale, lease, performance, or broadcast of copyrighted material (musical works, visual works, broadcasts, live performances, etc.) belonging to a third party in part or in whole without the permission of the copyright owner is forbidden by law.

## Options



Carrying Case  
**CB-CD2E**



Stereo Microphone  
**CS-15R**



Stereo Headphones  
**RH-300**



Support Stand  
**SS-PC1**

